

# Mast to Air Terminal Adaptor

## Data Solutions

### CATALOG NUMBER

---

**INTCPTMI16AT**



### FEATURES

---

Connects Conventional Air Terminal to SIM series Stainless Steel Mast

### PRODUCT ATTRIBUTES

---

Material: Stainless Steel 304L (EN 1.4306)

A: 2.05in

Diameter (Ø): 1.13in

Length 1 (L1): 0.98in

Length 2 (L2): 0.94in

Thread Size 1 (TS1): M16

Thread Size 2 (TS2): M25

## DIAGRAMS

---

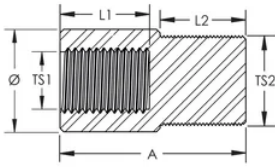

## WARNING

---

nVent products shall be installed and used only as indicated in nVent's product instruction sheets and training materials. Instruction sheets are available at [www.nvent.com](http://www.nvent.com) and from your nVent customer service representative. Improper installation, misuse, misapplication or other failure to completely follow nVent's instructions and warnings may cause product malfunction, property damage, serious bodily injury and death and/or void your warranty.



Our powerful portfolio of brands:

**CADDY ERICO HOFFMAN ILSCO SCHROFF TRACHTE**