

Front Panel, Shielded, Bottom Hinged

U-profile front panel bottom hinged for textile gasket.



CERTIFICATIONS



FEATURES

U-profile front panel can be unhinged at 135° (not RatiopacPRO) opening angle

Enables mounting on horizontal rails

Shielded, U front panel with textile EMC gasket

Suitable for subracks (EuropacPRO) and cases (RatiopacPRO, PropacPRO, CompacPRO)

SPECIFICATIONS

- Depth (D):** 2.5mm
- Material:** Aluminum
- Finish:** Anodized; Passivated
- Accessory Type:** Front panel
- Product Type:** Front Panel
- Type:** Front Panel without Handle

Table 1/2

| Catalog Number | Rack Height | Rack Width | Package Quantity | Mounting | Gasket Type | Front Finish |
|----------------|-------------|------------|------------------|----------------|-------------|--------------|
| 20848-599 | 3U | 42HP | 1 | Hinged, Bottom | Textile EMC | Anodized |
| 20848-604 | 6U | 84HP | 1 | Hinged, Bottom | Textile EMC | Anodized |

| Catalog Number | Rack Height | Rack Width | Package Quantity | Mounting | Gasket Type | Front Finish |
|----------------|-------------|------------|------------------|----------------|-------------|--------------|
| 20848-608 | 3U | 28HP | 1 | Hinged, Bottom | Textile EMC | Anodized |
| 20848-605 | 4U | 42HP | 1 | Hinged, Bottom | Textile EMC | Anodized |
| 20848-602 | 6U | 42HP | 1 | Hinged, Bottom | Textile EMC | Anodized |
| 20848-601 | 3U | 84HP | 1 | Hinged, Bottom | Textile EMC | Anodized |
| 20848-607 | 4U | 84HP | 1 | Hinged, Bottom | Textile EMC | Anodized |
| 20848-606 | 4U | 63HP | 1 | Hinged, Bottom | Textile EMC | Anodized |
| 20848-600 | 3U | 63HP | 1 | Hinged, Bottom | Textile EMC | Anodized |
| 20848-696 | 6U | 28HP | 1 | Hinged, Bottom | Textile EMC | Anodized |
| 20848-603 | 6U | 63HP | 1 | Hinged, Bottom | Textile EMC | Anodized |

Table 2/2

| Catalog Number | Rear Finish | Treated Edges | Complies With | EMC Shielding | Height (H) | Width (W) |
|----------------|-------------|---------------|---------------------------------|--------------------|------------|-----------|
| 20848-599 | Conductive | No | IEC 60297-3-101, IEEE 1101.1/10 | No (Retrofittable) | 128.4mm | 213mm |
| 20848-604 | Conductive | No | IEC 60297-3-101, IEEE 1101.1/10 | No (Retrofittable) | 261.8mm | 426.4mm |
| 20848-608 | Conductive | No | IEC 60297-3-101, IEEE 1101.1/10 | No (Retrofittable) | 128.4mm | 141.9mm |
| 20848-605 | Conductive | No | IEC 60297-3-101, IEEE 1101.1/10 | No (Retrofittable) | 172.9mm | 213mm |
| 20848-602 | Conductive | No | IEC 60297-3-101, IEEE 1101.1/10 | No (Retrofittable) | 261.8mm | 213mm |
| 20848-601 | Conductive | No | IEC 60297-3-101, IEEE 1101.1/10 | No (Retrofittable) | 128.4mm | 426.4mm |
| 20848-607 | Conductive | No | IEC 60297-3-101, IEEE 1101.1/10 | No (Retrofittable) | 172.9mm | 426.4mm |
| 20848-606 | Conductive | No | IEC 60297-3-101, IEEE 1101.1/10 | No (Retrofittable) | 172.9mm | 319.7mm |
| 20848-600 | Conductive | No | IEC 60297-3-101, IEEE 1101.1/10 | No (Retrofittable) | 128.4mm | 319.7mm |

| Catalog Number | Rear Finish | Treated Edges | Complies With | EMC Shielding | Height (H) | Width (W) |
|----------------|-------------|---------------|---------------------------------|--------------------|------------|-----------|
| 20848-696 | Conductive | No | IEC 60297-3-101, IEEE 1101.1/10 | No (Retrofittable) | 261.8mm | 141.9mm |
| 20848-603 | Conductive | No | IEC 60297-3-101, IEEE 1101.1/10 | No (Retrofittable) | 261.8mm | 319.7mm |

ADDITIONAL PRODUCT DETAILS

Front panel can be removed in opened position (> 135°).

DIAGRAMS

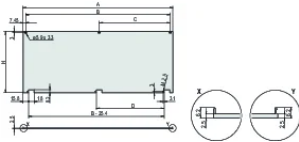

WARNING

nVent products shall be installed and used only as indicated in nVent's product instruction sheets and training materials. Instruction sheets are available at www.nvent.com and from your nVent customer service representative. Improper installation, misuse, misapplication or other failure to completely follow nVent's instructions and warnings may cause product malfunction, property damage, serious bodily injury and death and/or void your warranty.

North America

All locations
+1.763.422.2661
Chat with us:
nvent.com/schroff

Europe

Straubenhardt, Germany
+49.7082.794.0
Betschdorf, France
+33.3.88.90.64.90
Warsaw, Poland
+48.22.209.98.35
Assago, Italy
+39.02.932.7141
Chat with us:
nvent.com/schroff

Asia

Shanghai, China
+86.21.2412.6943
Qingdao, China
+86.532.8771.6101
Singapore
+65.6768.5800
Shin-Yokohama, Japan
+81.45.476.0271
Chat with us:
nvent.com/schroff

Middle East & India

Dubai, United Arab Emirates
+971.4.378.1700
Bangalore, India
+91.80.6715.2001
Istanbul, Turkey
+90.216.250.7374
Chat with us:
nvent.com/schroff



Our powerful portfolio of brands:

CADDY ERICO HOFFMAN ILSCO SCHROFF TRACHTE