

# L Joining Bracket

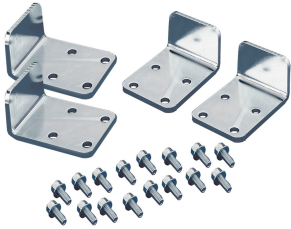

The L Joining Bracket is used in conjunction with the standard joining kit as additional support. Mounting hardware included.

## FEATURES

---

Brackets are 10-gauge steel, plated

Used in conjunction with joining kit for additional support

Mounting hardware included

## SPECIFICATIONS

Table 1/1

Catalog Number	Article Number	Material	Finish	Thickness
PJB2F	30829	Mild Steel	Plated	3.4mm

## WARNING

nVent products shall be installed and used only as indicated in nVent's product instruction sheets and training materials. Instruction sheets are available at [www.nvent.com](http://www.nvent.com) and from your nVent customer service representative. Improper installation, misuse, misapplication or other failure to completely follow nVent's instructions and warnings may cause product malfunction, property damage, serious bodily injury and death and/or void your warranty.



Our powerful portfolio of brands:

**CADDY ERICO HOFFMAN ILSCO SCHROFF TRACHTE**