

# Compression Straight Lug

## Data Solutions



### FEATURES

Tin plated for corrosion prevention

Annealed copper eases the crimping operation

Optimized sizes to the most efficient electrical conductivity

Best mechanical behavior (vibration/pull-out); DIN EN 61373 Class 1B "Railway Applications"

Markings on barrel for crimping

Consistent material thickness, precise diameter and accurate cable fit; DIN46235

### SPECIFICATIONS

**Material:** Copper

**Finish:** Tinned

Table 1/2

Catalog Number	Article Number	Lug/Connector Type	Conductor Size	Hole Size (HS)	Length (L)	Width (W)
PKS1610H		Heavy-Duty DIN46235	#6 Stranded, 16 mm <sup>2</sup> Stranded	10.5mm	48mm	17mm
RKS050019H	716546	Standard	300 mm <sup>2</sup> Stranded, 600 kcmil Stranded	13mm	109mm	43mm

CatalogNumber	Article Number	Lug/Connector Type	Conductor Size	Hole Size (HS)	Length (L)	Width (W)
RKS7012T	716656	Standard	2/0 Stranded, 70 mm <sup>2</sup> Stranded	13mm	59mm	23mm

Table 2/2

Catalog Number	Article Number	Tool/Die Type
PKS1610H		M2M or M2H/RKM2, M3H or M3B/RKM3, MLB/RKML
RKS050019H	716546	M2M or M2H/RKM2, M3H or M3B/RKM3
RKS7012T	716656	M2M or M2H/RKM2, M3H or M3B/RKM3, MLB/RKML

## DIAGRAMS

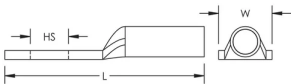

## WARNING

nVent products shall be installed and used only as indicated in nVent's product instruction sheets and training materials. Instruction sheets are available at [www.nvent.com](http://www.nvent.com) and from your nVent customer service representative. Improper installation, misuse, misapplication or other failure to completely follow nVent's instructions and warnings may cause product malfunction, property damage, serious bodily injury and death and/or void your warranty.



Our powerful portfolio of brands:

**CADDY ERICO HOFFMAN ILSCO SCHROFF TRACHTE**