

Compression Straight Lug, Standard, 185 mm² Stranded, 350 kcmil Stranded, 17 mm Hole

Data Solutions

CATALOG NUMBER

RKS18516T



FEATURES

Tin plated for corrosion prevention

Annealed copper eases the crimping operation

Optimized sizes to the most efficient electrical conductivity

Best mechanical behavior (vibration/pull-out); DIN EN 61373 Class 1B "Railway Applications"

Markings on barrel for crimping

Consistent material thickness, precise diameter and accurate cable fit; DIN46235

PRODUCT ATTRIBUTES

Article Number: 716663

Material: Copper

Finish: Tinned

Lug/Connector Type: Standard

Conductor Size: 185 mm² Stranded; 350 kcmil Stranded

Hole Size (HS): 17mm

Length (L): 83mm

Width (W): 35mm

Tool/Die Type: M2M or M2H/RKM2; M3H or M3B/RKM3; MLB/RKML

DIAGRAMS

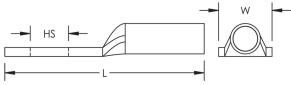

WARNING

nVent products shall be installed and used only as indicated in nVent's product instruction sheets and training materials. Instruction sheets are available at www.nvent.com and from your nVent customer service representative. Improper installation, misuse, misapplication or other failure to completely follow nVent's instructions and warnings may cause product malfunction, property damage, serious bodily injury and death and/or void your warranty.



Our powerful portfolio of brands:

CADDY ERICO HOFFMAN ILSCO SCHROFF TRACHTE