

# Pin Driven Angle Bracket



## CERTIFICATIONS



## FEATURES

Longer leg angle bracket for tool clearance

Designed to fit a variety of pin drivers

Improved for easier installation with pin drivers

Preassembly options available for rod, wire, strap and cable applications

## SPECIFICATIONS

**Finish:** Pregalvanized

**Material:** Steel

Table 1/2

Catalog Number	Hole Size 1 (HS1)	Hole Size 2 (HS2)	Height (H)	Length (L)	Width (W)	A
AFAB3	4.8 mm	7.1 mm	50.8 mm	44.2mm	28.6 mm	7.1 mm
AFAB4	7.1 mm	7.1 mm	50.8 mm	44.2mm	28.6 mm	7.1 mm
AFAB6	10.2 mm	7.1 mm	50.8 mm	44.2mm	28.6 mm	7.1 mm

Table 2/2

Catalog Number	B	Static Load
AFAB3	16.9 mm	700N
AFAB4	16.9 mm	1550N
AFAB6	16.9 mm	1550N

## ADDITIONAL PRODUCT DETAILS

Load limits apply to nVent CADDY Fasteners only.

Pin must be evaluated separately.

## DIAGRAMS

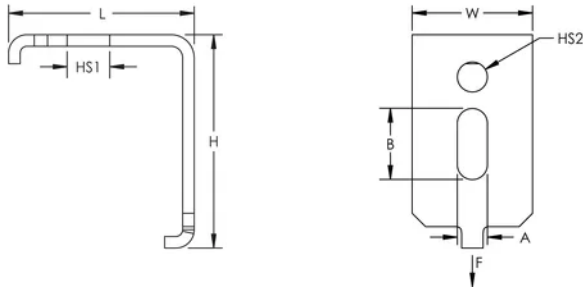

## WARNING

nVent products shall be installed and used only as indicated in nVent's product instruction sheets and training materials. Instruction sheets are available at [www.nvent.com](http://www.nvent.com) and from your nVent customer service representative. Improper installation, misuse, misapplication or other failure to completely follow nVent's instructions and warnings may cause product malfunction, property damage, serious bodily injury and death and/or void your warranty.

### North America

+1.800.753.9221  
Option 1 – Customer Care  
Option 2 – Technical  
Support

### Europe

Netherlands:  
+31 800-0200135  
France:  
+33 800 901 793

### Europe

Germany:  
800 1890272  
Other Countries:  
+31 13 5835404

### APAC

Shanghai:  
+ 86 21 2412 1618/19  
Sydney:  
+61 2 9751 8500



Our powerful portfolio of brands:

**CADDY ERICO HOFFMAN ILSCO SCHROFF TRACHTE**

