

Compression Straight Lug, Heavy-Duty DIN46235, #6 Stranded, 16 mm² Stranded, 10.5 mm Hole

Data Solutions

CATALOG NUMBER

PKS1610H



FEATURES

Tin plated for corrosion prevention

Annealed copper eases the crimping operation

Optimized sizes to the most efficient electrical conductivity

Best mechanical behavior (vibration/pull-out); DIN EN 61373 Class 1B "Railway Applications"

Markings on barrel for crimping

Consistent material thickness, precise diameter and accurate cable fit; DIN46235

PRODUCT ATTRIBUTES

Material: Copper

Finish: Tinned

Lug/Connector Type: Heavy-Duty DIN46235

Conductor Size: #6 Stranded; 16 mm² Stranded

Hole Size (HS): 10.5mm

Length (L): 48mm

Width (W): 17mm

Tool/Die Type: M2M or M2H/RKM2; M3H or M3B/RKM3; MLB/RKML

DIAGRAMS

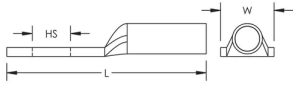

WARNING

nVent products shall be installed and used only as indicated in nVent's product instruction sheets and training materials. Instruction sheets are available at www.nvent.com and from your nVent customer service representative. Improper installation, misuse, misapplication or other failure to completely follow nVent's instructions and warnings may cause product malfunction, property damage, serious bodily injury and death and/or void your warranty.



Our powerful portfolio of brands:

CADDY ERICO HOFFMAN ILSCO SCHROFF TRACHTE