

# Compression Straight Lug, Standard, 240 mm<sup>2</sup> Stranded, 500 kcmil Stranded, 0.67" Hole

## Data Solutions

### CATALOG NUMBER

**RKS24016T**



### FEATURES

Tin plated for corrosion prevention

Annealed copper eases the crimping operation

Optimized sizes to the most efficient electrical conductivity

Best mechanical behavior (vibration/pull-out); DIN EN 61373 Class 1B "Railway Applications"

Markings on barrel for crimping

Consistent material thickness, precise diameter and accurate cable fit; DIN46235

### PRODUCT ATTRIBUTES

Material: Copper

Finish: Tinned

Lug/Connector Type: Standard

Conductor Size: 240 mm<sup>2</sup> Stranded; 500 kcmil Stranded

Hole Size (HS): 17mm

Length (L): 93mm

Width (W): 39mm

## DIAGRAMS

---

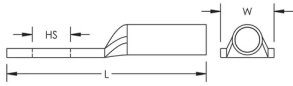

## WARNING

---

nVent products shall be installed and used only as indicated in nVent's product instruction sheets and training materials. Instruction sheets are available at [www.nvent.com](http://www.nvent.com) and from your nVent customer service representative. Improper installation, misuse, misapplication or other failure to completely follow nVent's instructions and warnings may cause product malfunction, property damage, serious bodily injury and death and/or void your warranty.



Our powerful portfolio of brands:

**CADDY   ERICO   HOFFMAN   ILSCO   SCHROFF   TRACHTE**